



Peder Skrams Gade 13  
DK-1054 Copenhagen K  
[www.specta.dk](http://www.specta.dk)  
+45 3313 0123  
[specta@specta.dk](mailto:specta@specta.dk)

## *RECOLLECTION - Beyond the Design*

benandsebastian, Ditte Ejlerskov, Anette Harboe Flensburg,  
Jakob Hunosøe, Johannes Sivertsen, Daniel Svarre





Peder Skrams Gade 13  
DK-1054 Copenhagen K  
www.specta.dk  
+45 3313 0123  
specta@specta.dk

## **RECOLLECTION - Beyond the Design**

**benandsebastian, Ditte Ejlerskov, Anette Harboe Flensburg, Jakob Hunosøe,  
Johannes Sivertsen, Daniel Svarre**

May 24 - June 28, 2019

**In Denmark, a long and democratic design tradition has made design an indispensable part of most people's everyday lives. Design is considered a natural part of life - from home objects, the furniture of institutions, to the spaces and buildings we inhabit. But what was your actual experience? And how do your experiences with the design affect your memories of it? SPECTA's new exhibition *Recollection - Beyond the Design* focuses on the shifts and displacements that occur when it is the interaction with the design which is being reproduced.**

benandsebastian's work *Stored* is based on a display cabinet created by Kaare Klint in 1926 for the Danish Design Museum. A display cabinet, with the purpose of framing exhibited objects. In benandsebastian's work, the cabinet houses life, to be understood as a frame containing basic functional needs of the human being: chair, table, bed, storage. Thus, it is daily life itself, which is *Stored*. Or maybe it's locked up and put in a tight frame? In this way, the work highlights the strength of the iconic designer and at the same time the yoke, or the restraints, that the strong design tradition impose on new generations.

*Chair for Education II* is Daniel Svarre's rendering of the school chair from the 1970s primary school. Many will recognize the simple, robust design created to endure wear and tear. But in Svarres' work five versions of the chair are included. One stands over the other, not stacked, but designed so they all stand on the floor. The sculpture is ambiguous, and it appears both very hierarchical, and at the same time as if it grows.

In other works on show, shifts or displacements occur, as e.g. in Ditte Ejlerskov's painting of a seemingly quite ordinary house. At the same time *The Real Blue House* is not just any house, as it is the childhood home of pop icon Rihanna. In this way, we look differently at the house, and it means something else in our minds. This also applies to Johannes Sivertsen's double painting *Model - La cité radieuse*, which is a detailed representation of a model of le Corbusier's well-known building in Marseille. The building has become a still life, a lost dream.

Jakob Hunosøe and Anette Harboe Flensburg both work with illusions and displacements in arrangements of objects and constructions of space. Flensburg paints her interiors from spatial models, and Hunosøe photographs well-known elements which in new arrangements disturbs our sense of scale, lines and abstraction.

In the process towards realization, objects or architecture can be described as a series of aesthetic and functional considerations which, together with intention, translate into a concrete element. But when we as individuals use, meet and adopt design and architecture, new layers are added based on personal experiences. Objects, buildings and spaces turn into something else - or something more - than the original intentions and considerations of the designer. Showing works by benandsebastian, Ditte Ejlerskov, Anette Harboe Flensburg, Jakob Hunosøe, Johannes Sivertsen and Daniel Svarre, *Recollection - Beyond the Design* is about such layers of experience.

Ditte Ejlerskov

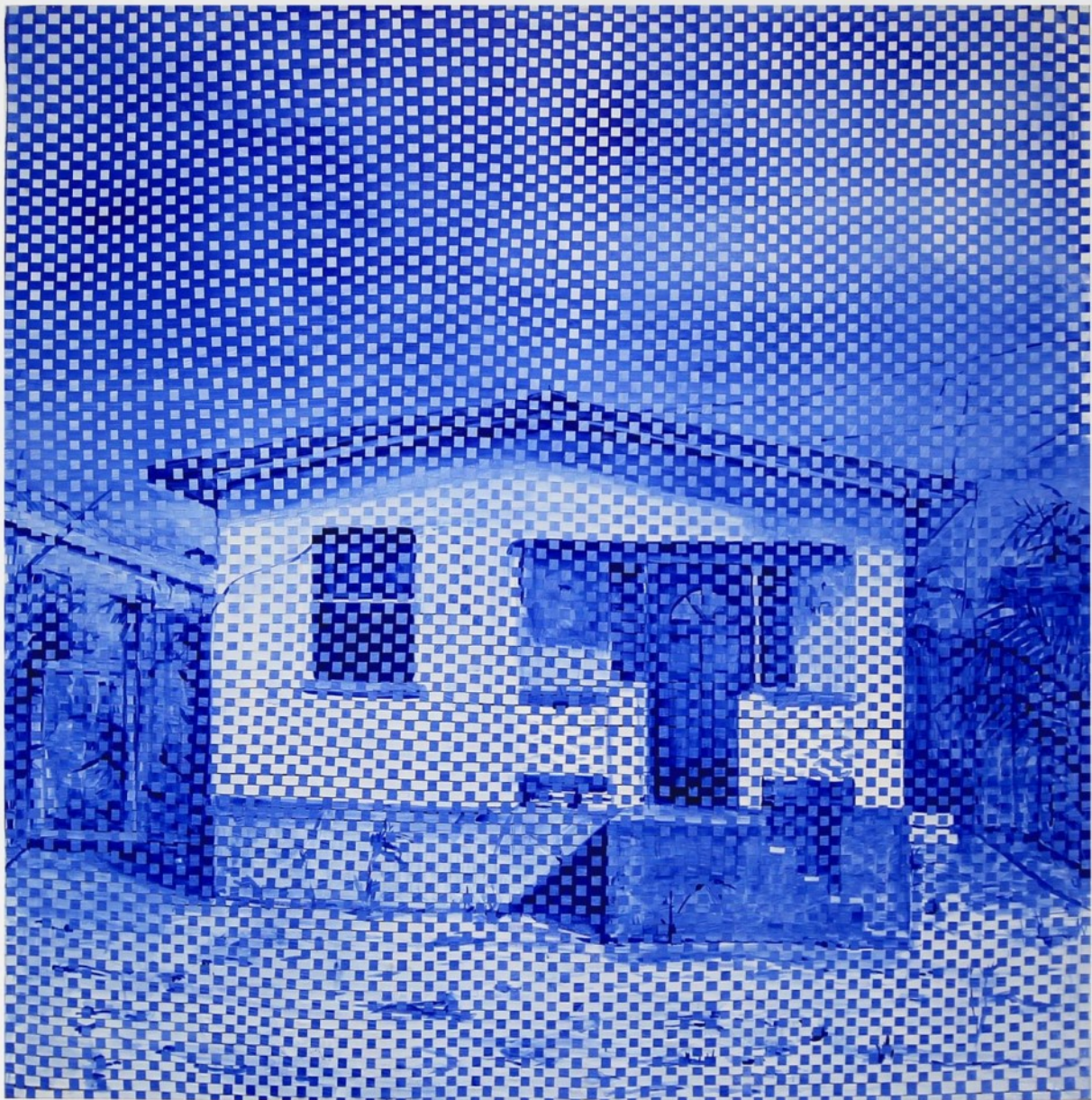

*The Real Blue House,*  
2017

oil on two canvases, weaved together

160 x 160 cm

Euros 6.900,-



Daniel Svarre



*Chair for Education #2, 2018*

five modified chairs

81 x 41 x 65 cm

Euros 5.500,-

Daniel Svarre



*Painted Shield #7, 2017*  
jesmonite, acrylic paint  
54 x 41 x 26 cm  
Euros 2.700,-



Jakob Hunsøe



*Vandflaske (Waterbottle), 2018*  
archival fiber print  
50 x 50 cm  
ed 5  
Euros 1.650,-



**Jakob Hunsøe**



*Objects of Various Size*, 2015  
 archival fiber print  
 46,5 x 46,5 cm (framed)  
 ed 5  
 Euros 1.350,-



*Kniv, Vase, Lampe (Knife, Vase, Lamp)*, 2019  
 archival fiber print  
 46,5 x 46,5 cm (framed)  
 ed 5  
 Euros 1.350,-

**Jakob Hunsøe**

*Two Plastic Balls and Four Tomatoes, 2017*

archival fiber print  
46,5 x 46,5 cm (framed)  
ed 5  
Euros 1.350,-



*The Inside of a Watering Can Painted Black, 2019*

archival fiber print  
46,5 x 46,5 cm (framed)  
ed 5  
Euros 1.350,-



Jakob Hunsøe

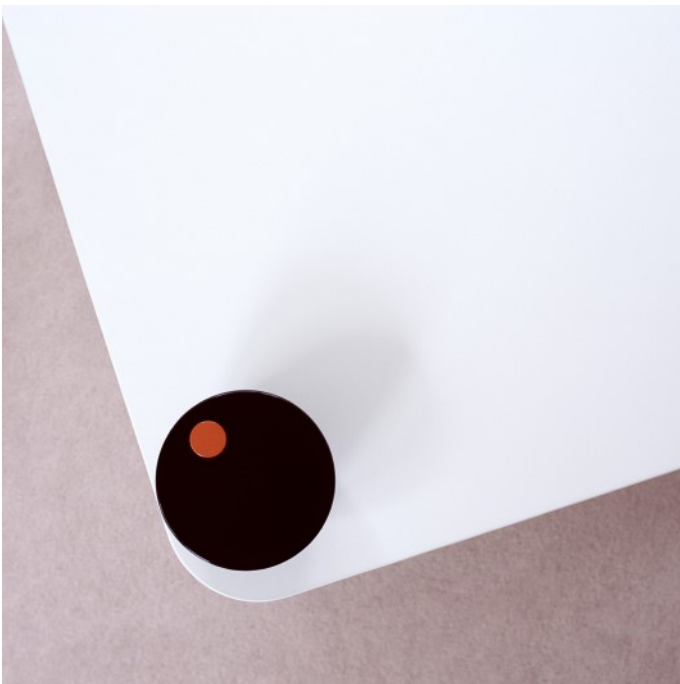

*Thermos Lid on Table*, 2018  
 archival fiber print  
 46,5 x 46,5 cm (framed)  
 ed 5  
 Euros 1.350,-



*Beam of Light Projected on a Wall*, 2017  
 archival fiber print  
 46,5 x 46,5 cm (framed)  
 ed 5  
 Euros 1.350,-

Jakob Hunsøe



*Balloons*, 2018  
archival fiber print  
120 x 100 cm (framed)  
ed 5  
Euros 2.450,-

Johannes Sivertsen

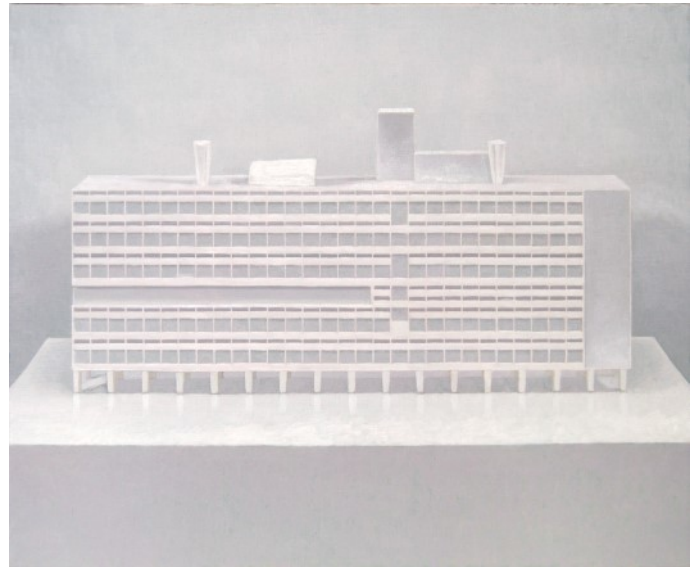
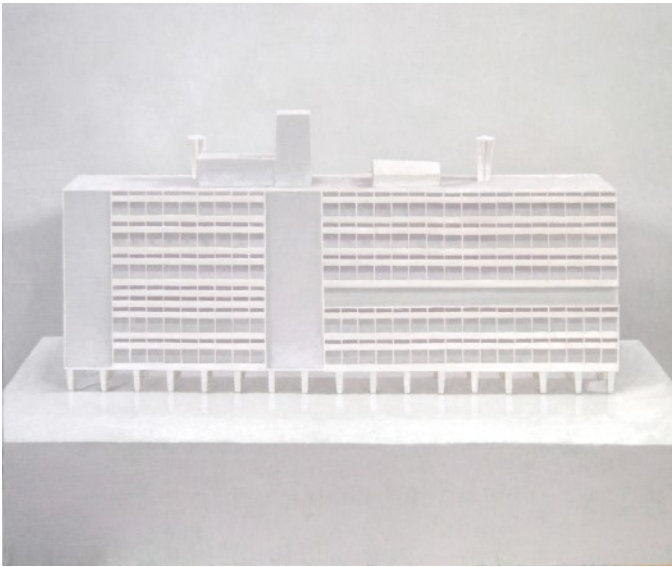

*La Cité Radieuse*, 2019  
 Oil on canvas  
 2 pcs, each 46 x 55 cm  
 Euros 2.400,- (total)



benandsebastian



*Stored*, 2013

Teak, leather, paperyarn, brass

- mutated teak vitrine, after original by Kaare Klint

80 x 80 x 191 cm

Euros 40.000,-



**Anette Harboe Flensburg**



*You Lie in the Dark, and are Back in that Light, 2018*

oil on canvas

60 x 80 cm

Euros 4.750,-

**Anette Harboe Flensburg**



*In the Same Dark or in Another I*, 2018  
oil on canvas  
30 x 40 cm  
Euros 2.600,-



*In the Same Dark or in Another II*, 2018  
oil on canvas  
30 x 40 cm  
Euros 2.600,-